

# **CORDLESS WEED SWEEPER**

**Cat. No.: 25281(Model.: N0E-13ET-100)**

## **INSTRUCTION MANUAL**



### **WARNING: READ THIS MANUAL BEFORE USING !**

For your safety and for proper operation and maintenance, Please read carefully and keep readily available for future reference

## 1. INSTRUCTION:

This device is designed to remove dusts and weeds from between paving stones and slabs. It is not intended for use on sensitive surfaces like tiles. It is to be used only for its prescribed purpose, not for use in commercial, trade or industrial applications. The operator and not the manufacturer will be liable for any damage or injuries of any kind caused as a result of improper use.

## 2. EXTENT OF DELIVERY

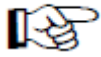

After unpacking, check the contents of the box (Fig.1)

Please check for any damages. Report any damage or missing items to your dealer, supplier immediately, complaints made at a later date will not be acknowledged

- |                  |                           |
|------------------|---------------------------|
| 1. Manual        | 8. Steel brush            |
| 2. Main housing  | 9. Nylon brush            |
| 3. Battery pack  | 10. Wheel                 |
| 4. Handle        | 11. 2 x screws 3.5x13     |
| 5. Charging base | 12. Nut M8                |
| 6. Adaptor       | 13. 1 x open-ended wrench |
| 7. Guard hood    | 14. 1 x pin               |

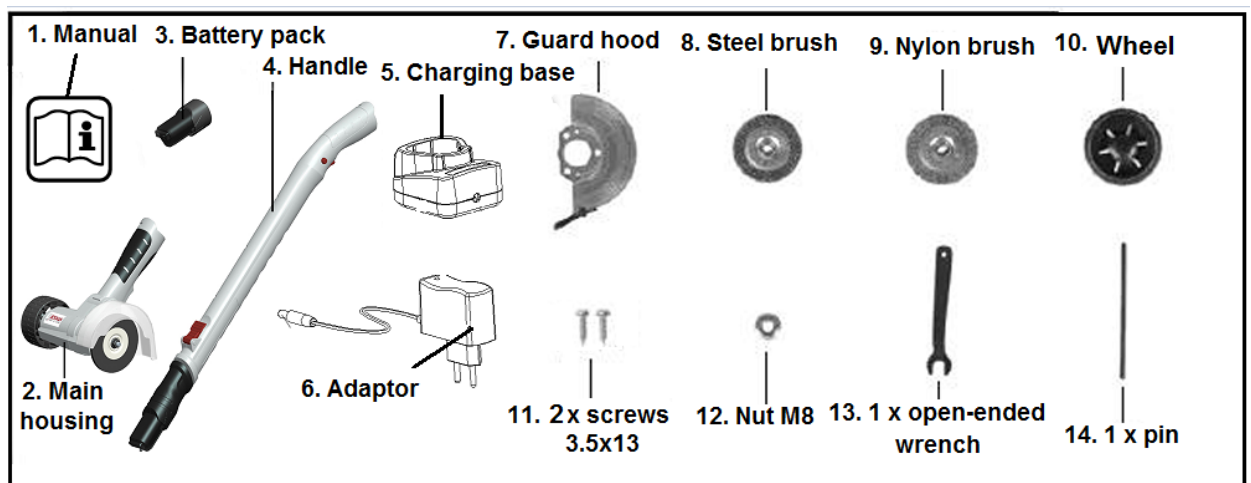
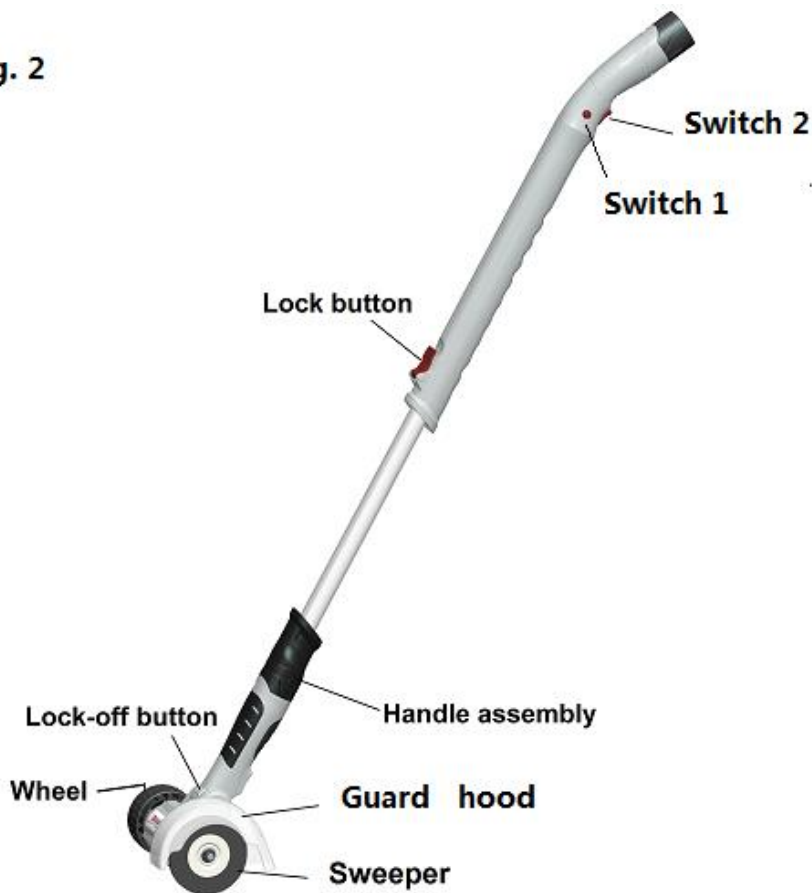

Fig.1

### 3. DESCRIPTION OF THE DEVICE :

1. Switch 1 & 2
2. Lock button
3. Handle assembly
4. Lock-off button
5. Wheel
6. Guard hood
7. Sweeper

Fig. 2



### 4. TECHNIAL DATA

Model	N0E-13ET-100 (Cat.No.: 25281)
Voltage	7.2VDC
No Load Speed	1200 /min
Max. brush diameter	100mm
Battery type	Lithium-ion
Battery capacity	1.3Ah
Battery charging time	Approx. 4 hours
No load working time	About 30 minutes
Weight	1.7 kg

## 5. EXPLANATION OF SYMBOLS



Carefully read operator's manual before handling the machine  
Observe instructions and safety rules when operating.



Shut off engine and remove power cord before performing  
cleaning and maintenance.



Danger – objects may be thrown out at high speed when motor  
is running. Keep people, pets and domestic animals out of the  
danger area.



Beware of the rotating tool.  
Keep hands and feet out of openings while machine is running.



Protect against moisture.



Wear eye and ear protection.



Should your machine need replacement after extended use, do not  
put in the domestic waste but dispose of it in an environmentally  
safe way.

## 6. GENERAL SAFETY INSTRUCTIONS

**WARNING** Read all safety warnings and all instructions. Failure to follow the warnings and instructions may result in electric shock, fire and/or serious injury.

**Save all warnings and instructions for future reference.**

The term "power tool" in the warnings refers to your mains-operated (corded) power tool or Battery-operated power tool.

### 1) Work area safety

- a) **Keep work area clean and well lit.** Cluttered or dark areas invite accidents.
- b) **Do not operate power tools in explosive atmospheres, such as in the presence of flammable liquids, gases or dust.** Power tools create sparks which may ignite the dust or fumes.
- c) **Keep children and bystanders away while operating a power tool.** Distractions can cause you to lose control.

### 2) Electrical safety

- a) **Power tool plugs must match the outlet. Never modify the plug in any way. Do not use any adapter plugs with earthed (grounded) power tools.** Unmodified plugs and matching outlets will reduce risk of electric shock.
- b) **Avoid body contact with earthed or grounded surfaces, such as pipes, radiators, ranges and refrigerators.** There is an increased risk of electric shock if your body is earthed or grounded.
- c) **Do not expose power tools to rain or wet conditions.** Water entering a power tool will increase the risk of electric shock.
- d) **Do not abuse the cord. Never use the cord for carrying, pulling or unplugging the power tool. Keep cord away from heat, oil, sharp edges or moving parts.** Damaged or entangled cords increase the risk of electric shock.
- e) **When operating a power tool outdoors, use an extension cord suitable for outdoor use.** Use of a cord suitable for outdoor use reduces the risk of electric shock.
- f) **If operating a power tool in a damp location is unavoidable, use a residual current device (RCD) protected supply.** Use of an RCD reduces the risk of electric shock. NOTE The term "residual current device (RCD)" may be replaced by the term "ground fault circuit interrupter (GFCI)" or "earth leakage circuit breaker (ELCB)".

### 3) Personal safety

- a) **Stay alert, watch what you are doing and use common sense when operating a power tool. Do not use a power tool while you are tired or under the influence of drugs, alcohol or medication.** A moment of inattention while operating power tools may result in serious personal injury.

- b) **Use personal protective equipment. Always wear eye protection.** Protective equipment such as dust mask, non-skid safety shoes, hard hat, or hearing protection used for appropriate conditions will reduce personal injuries.
- c) **Prevent unintentional starting. Ensure the switch is in the off-position before connecting to power source and/or battery pack, picking up or carrying the tool.** Carrying power tools with your finger on the switch or energising power tools that have the switch on invites accidents.
- d) **Remove any adjusting key or wrench before turning the power tool on.** A wrench or a key left attached to a rotating part of the power tool may result in personal injury.
- e) **Do not overreach. Keep proper footing and balance at all times.** This enables better control of the power tool in unexpected situations.
- f) **Dress properly. Do not wear loose clothing or jewellery. Keep your hair, clothing and gloves away from moving parts.** Loose clothes, jewellery or long hair can be caught in moving parts.
- g) **If devices are provided for the connection of dust extraction and collection facilities, ensure these are connected and properly used.** Use of dust collection can reduce dust-related hazards.

#### 4) **Power tool use and care**

- a) **Do not force the power tool. Use the correct power tool for your application.** The correct power tool will do the job better and safer at the rate for which it was designed.
- b) **Do not use the power tool if the switch does not turn it on and off.** Any power tool that cannot be controlled with the switch is dangerous and must be repaired.
- c) **Disconnect the plug from the power source and/or the battery pack from the power tool before making any adjustments, changing accessories, or storing power tools.** Such preventive safety measures reduce the risk of starting the power tool accidentally.
- d) **Store idle power tools out of the reach of children and do not allow persons unfamiliar with the power tool or these instructions to operate the power tool.** Power tools are dangerous in the hands of untrained users.
- e) **Maintain power tools. Check for misalignment or binding of moving parts, breakage of parts and any other condition that may affect the power tool's operation. If damaged, have the power tool repaired before use.** Many accidents are caused by poorly maintained power tools.
- f) **Keep cutting tools sharp and clean.** Properly maintained cutting tools with sharp cutting edges are less likely to bind and are easier to control.
- g) **Use the power tool, accessories and tool bits etc. in accordance with these instructions, taking into account the working conditions and the work to be performed.** Use of the power tool for operations different from those intended could result in a hazardous situation.

## **5) Battery tool use and care**

a) **Recharge only with the charger specified by the manufacturer.** A charger that is suitable for one type of battery pack may create a risk of fire when used with another battery pack.

b) **Use power tools only with specifically designated battery packs.** Use of any other battery packs may create a risk of injury and fire.

c) **When battery pack is not in use, keep it away from other metal objects, like paper clips, coins, keys, nails, screws or other small metal objects, that can make a connection from one terminal to another.** Shorting the battery terminals together may cause burns or a fire.

d) **Under abusive conditions, liquid may be ejected from the battery; avoid contact. If contact accidentally occurs, flush with water. If liquid contacts eyes, additionally seek medical help.** Liquid ejected from the battery may cause irritation or burns.

## **6) Service**

a) **Have your power tool serviced by a qualified repair person using only identical replacement parts.** This will ensure that the safety of the power tool is maintained.

## **7) Storage**

a) use of transport guard during transport and storage

b) cleaning and maintenance before storage

c) securing of the unit during transport to prevent loss of fuel, damage or injury

## **7. BATTERY CHARGING**

The battery is supplied partially charged. To ensure full capacity of the battery, completely charge the battery in the battery charger before using your power tool for the first time.

A battery that is new or has not been used for a longer period does not develop its full capacity until after approx. 5 charging/discharging cycles.

When the machine can not rotate while the On/Off switch is pressed, then the battery has no enough capacity and should be charged.

The charger is consisted of the adaptor (6) and the charging base (5)

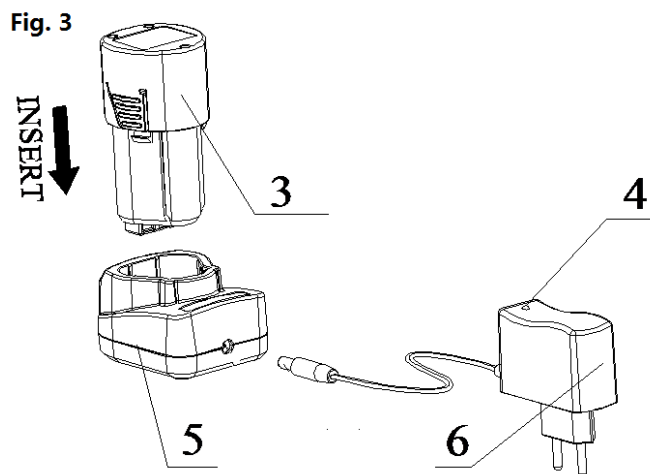

- 1) Plug cord from the adaptor (6) into charging base (5). (IMPORTANT: do not use any other charger, only use the charger comes with the product)
- 2) Plug the adaptor into an appropriate AC power outlet. The LED light (4) of the charger turns green indicating that the charger is ready for use. (IMPORTANT: Do not charge by means of an engine generator or DC power source.)
- 3) Insert the battery pack (3) into the charging base. The LED light turns red, telling the battery is on charge. Let battery charge up to full.
- 4) The battery pack will be fully charged in about 4 hours. And the LED lights green again to tell you that the battery pack is fully charged. Then unplug the adaptor.

### IMPORTANT CHARGING NOTES

- 1) After normal usage, your battery pack should be fully charged in about 4 hours. Allow the battery to cool down before charging after using the saw. (NOTE: A hot battery placed in the charger will not charge)
- 2) DO NOT charge the battery pack in an air temperature below 40°F (4.5 °C) or above 105°F (40.5 °C). This is important and will prevent serious damage to the battery pack. Longest life and best performance can be obtained if battery pack is charged when air temperature is about 75°F (24°C).
- 3) While charging, the charger may hum and become warm to touch. This is a normal condition and does not indicate a problem.
- 4) If the battery pack does not charge properly
  - a) Check current at receptacle by plugging in a lamp or other appliance.
  - b) Check to see if receptacle is connected to a light switch which turns power off when you turn out the lights.
  - c) Move charger and battery pack to a surrounding air temperature of 40°F (4.5°C) to 105°F (40.5 °C)



- 5) The battery pack need to be charged before first using and should be recharged when it fails to produce sufficient power on jobs which were easily done previously. **DO NOT CONTINUE** using this product with its battery pack in a depleted condition. (NOTE: After several charge and discharge cycles, the battery will attain full capacity.)
- 6) To prolong battery life, avoid leaving the battery pack on charger for extended periods of time (over 30 days without use). Although overcharging is not a safety concern, it can significantly reduce overall battery life.
- 7) The battery pack will reach optimum performance after being cycled 5 times during normal usage. There is no need to run the batteries down completely before recharging. Normal usage is the best method of discharging and recharging the batteries.

### **Additional safety instructions for battery and charger**

#### **Battery**

- Never attempt to open for any reason
- Do not expose to water
- Do not incinerate the battery pack even if it is severely damaged or is completely worn out. The battery pack can explode in a fire.
- Do not store in locations where the temperature may exceed 40°C
- Do not leave the battery pack in the charger when the charging is finished, otherwise battery leakage may occur.
- Charge only at room temperature.
- Charge only at using the charger provided with the tool (see technical data)
- Before charging , make sure that the battery is dry and clean.
- Use only the correct type of battery for the tool(see technical data).
- When dispose of batteries follow the instructions given in the section "protecting the environment".
- Under extreme conditions ,battery leakage may occur .When you notice liquid on the battery, proceed as follows:
  - Carefully wipe the liquid off using a cloth. Avoid skin contact.
  - In case of skin or eye contact, follow the instructions below.

The battery fluid, a 25-30% solution of potassium hydroxide, can be harmful. In case of skin contact, immediately rinse with water. Neutralize with a mild acid such as lemon juice or vinegar. In case of eye contact, rinse abundantly with clean water for at least 10 minutes. Consult a physician.

**NOTE: The batteries in your battery pack are the Lithium-Ion type. Do not dispose of battery packs/batteries into household waste, fire or water. Battery packs/batteries should be collected, recycled or disposed of in an environmental-friendly manner.**

## Charger

- **Charger's plug must match the outlet. Never modify the plug in any way.** Unmodified plugs and matching outlets will reduce risk of electric shock.
- Use your charger only to charge batteries of the type supplied with your tool. Other batteries could burst, causing personal injury and damage.
- Only 2 battery packs is allowed to be charged continuously in order to prevent overheating of charger, necessary rest time is required to let the charger cool down before further charging.
- When charging is finished, unplug the charger from mains socket outlet and take away the battery pack from the charger, do not leave the battery pack in the charger.
- Never carry the charger by its cord or pull it to disconnect from the socket. Keep the cord away from heat, oil and sharp edges.
- Never attempt to charge non-rechargeable batteries.
- The cord of charger is not changeable, do not continue to use if the cord is damaged.
- Do not expose to water or rain, do not use in wet condition.
- Do not open the charger.
- Do not probe the charger.
- Intended for indoor use only

## 8. ASSEMBLY

- Insert the wheel to the machine head (Fig.4)
- Clip on the guard hood to the machine head and tighten it with 2 screws (11) (Fig.5)

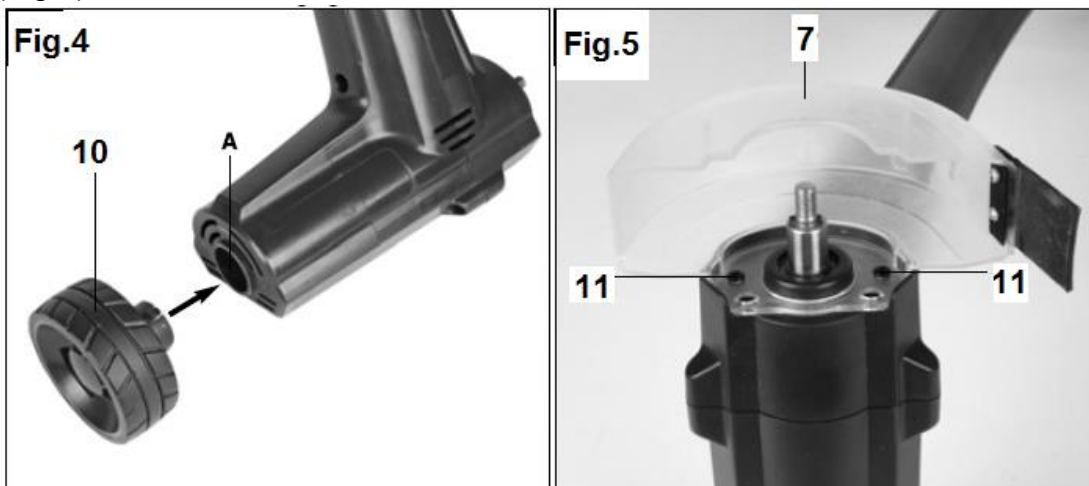

- Fit the brush (A) onto the drive axle (B), make sure that the brush fits accurately into the mount (C) (Fig. 6)
- Fixed the shaft to fasten the steel/Nylon brush (8/9): insert the pin (14) into the recess on the shaft and hold with one hand, use the open-ended wrench (13) to fix the brush with the nut (12) (Fig.7)

**Important**

**Be sure to remove the pin again from the shaft.**

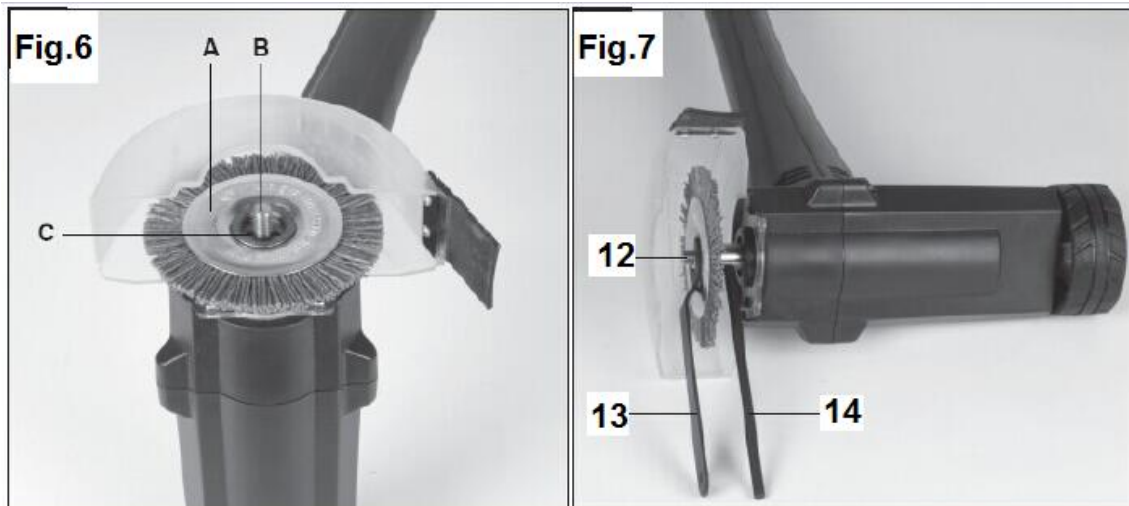

- Insert the handle to the main housing (Fig.8 )
- Insert the battery to the handle, then the device is ready for use.

**Fig.8**



**9. OPERATION:**

**1) Adjust the handle to a suitable height (Fig. 9 )**

The device is with the telescopic handle. You can adjust the handle as required.

- Open the lock button (3), use one hand to hold the tube (5). the other hand to hold the handle (4) to pull out
- Pull out to your desired height, then press the lock button to lock it.

**Warning:** Do not turn on the switch (1,2) when you adjust the handle. This can cause a serious injury.

**Fig.9**

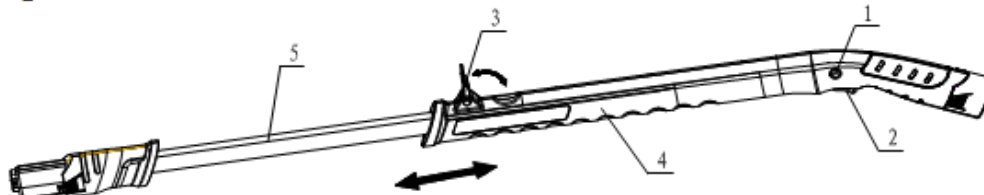

**2) Fit the sweeper head to a suitable position (Fig.10 )**

The machine is with the swivel head. You can adjust the sweeper head to your desired position.

- Hold the handle tightly. Press the lock-off button and turn the sweeper head to the desired position.
  - Release the lock-off button again and check whether the sweeper head is locked in place.
- (Note: The sweeper head can be locked in four positions (0°、18°、36°、54°)).

**Fig. 10**



### 3) ON/OFF switch

- Press and hold Switch 1 first, and then press Switch 2
- Press and hold Switch 2, then release Switch 1 but continue to squeeze switch 1 for continued operation.
- Release switch 2 to stop the machine.

Fig. 11



### **⚠ Important**

- Always carry out a short trial run to check out possible effects on the surfaces of the paving stones or slabs before starting with your work. Never use the equipment on very sensitive surfaces, for example tiles.
- Only use brushes which are in good condition. Replace excessively worn or damaged brushes immediately.
- Always use both hands to operate the equipment.
- Guide the equipment along the joints at a walking pace.
- For uniform results, carry out your work at a constant speed.
- If necessary, guide the equipment along the same joint several times.

### 4). Replace the brush

One steel brush (Fig. 2/Item 8) and one nylon brush (Fig. 2/Item 9) are supplied with the equipment. The steel brush is suited for use on robust surfaces and obstinate weeds. The nylon brush is for light vegetation.

To dismantle the equipment for changing the brush proceed in reverse order.(Fig. 7)

## 10. DISPOSAL:

The packaging material is reusable. Dispose of the packaging in an environmentally friendly way by putting it in the appropriate recyclable waste collection containers.



Dispose of the product and the batteries in view of the environment if you want to separate. The device and the batteries must not be thrown in with domestic waste. Take them to a recycling center for used electrical and electronic devices. For more information you can consult your local government. Remove batteries first.

Eurotops Versand GmbH  
Elisabeth-Selbert-Straße 3  
40764 Langenfeld, Germany



If technical support is needed, please call ...

in Germany 0180 . 530 63 63\* or [info@eurotops.de](mailto:info@eurotops.de)

in Austria 01 . 230 60 43 12 or [info@eurotops.at](mailto:info@eurotops.at)

in Switzerland 044 . 28 36 125 or [info@eurotops.ch](mailto:info@eurotops.ch)

in the Netherlands 026 . 37 36 333 or [info@eurotops.nl](mailto:info@eurotops.nl)

in France 0892 . 700 470\*\* or [info@eurotops.fr](mailto:info@eurotops.fr)

\* 14 Cents/minute via German landline, max. 42 cents/minute via mobile phone network

\*\*34 Cents/minute via French landline

A possible return of products should be addressed to the return address stated on your invoice.

The manual only reflects the technical conditions available under printing. Any changes in technology and equipment are reserved.

© 12.11.2014